



# 6208-RS1 Deep groove ball bearings

- SKF Explorer

## Deep groove ball bearings

### Bearing data

[Tolerances](#),

Normal (metric), P6, P5, Normal (inch),

[Radial internal clearance](#),

Matched bearing pairs, Stainless steel  
 $d < 10$  mm, Other bearings

### Bearing interfaces

[Seat tolerances for standard conditions](#),

[Tolerances and resultant fits](#)

## Technical specification

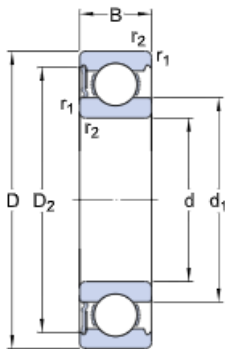

### DIMENSIONS

d	40 mm	Bore diameter
D	80 mm	Outside diameter
B	18 mm	Width
$d_1$	≈ 52.6 mm	Shoulder diameter
$D_2$	≈ 69.8 mm	Recess diameter
$r_{1,2}$	min. 1.1 mm	Chamfer dimension

### ABUTMENT DIMENSIONS

$d_c$ min.	47 mm	Diameter of shaft abutment
$d_c$ max.	52.5 mm	Diameter of shaft abutment
$D_i$ max.	73 mm	Diameter of housing abutment
$r_a$ max.	1 mm	Radius of shaft or housing fillet

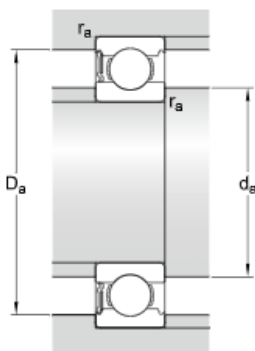

## CALCULATION DATA

C	32.5 kN	Basic dynamic load rating
C <sub>0</sub>	19 kN	Basic static load rating
P <sub>u</sub>	0.8 kN	Fatigue load limit
	5 600 r/min	Limiting speed
k <sub>r</sub>	0.025	Minimum load factor
f <sub>0</sub>	13.8	Calculation factor

## MASS

	0.37 kg	Mass bearing
--	---------	--------------

## TOLERANCE CLASS

P6	Dimensional tolerances
P6	Radial run-out